

LOC		DIST		REVISIONS			
AD	00	P	LTR	DESCRIPTION	DATE	OWN	APPD
		P		REVISED PER ECO-11-004835	11MAR11	RK	HMR

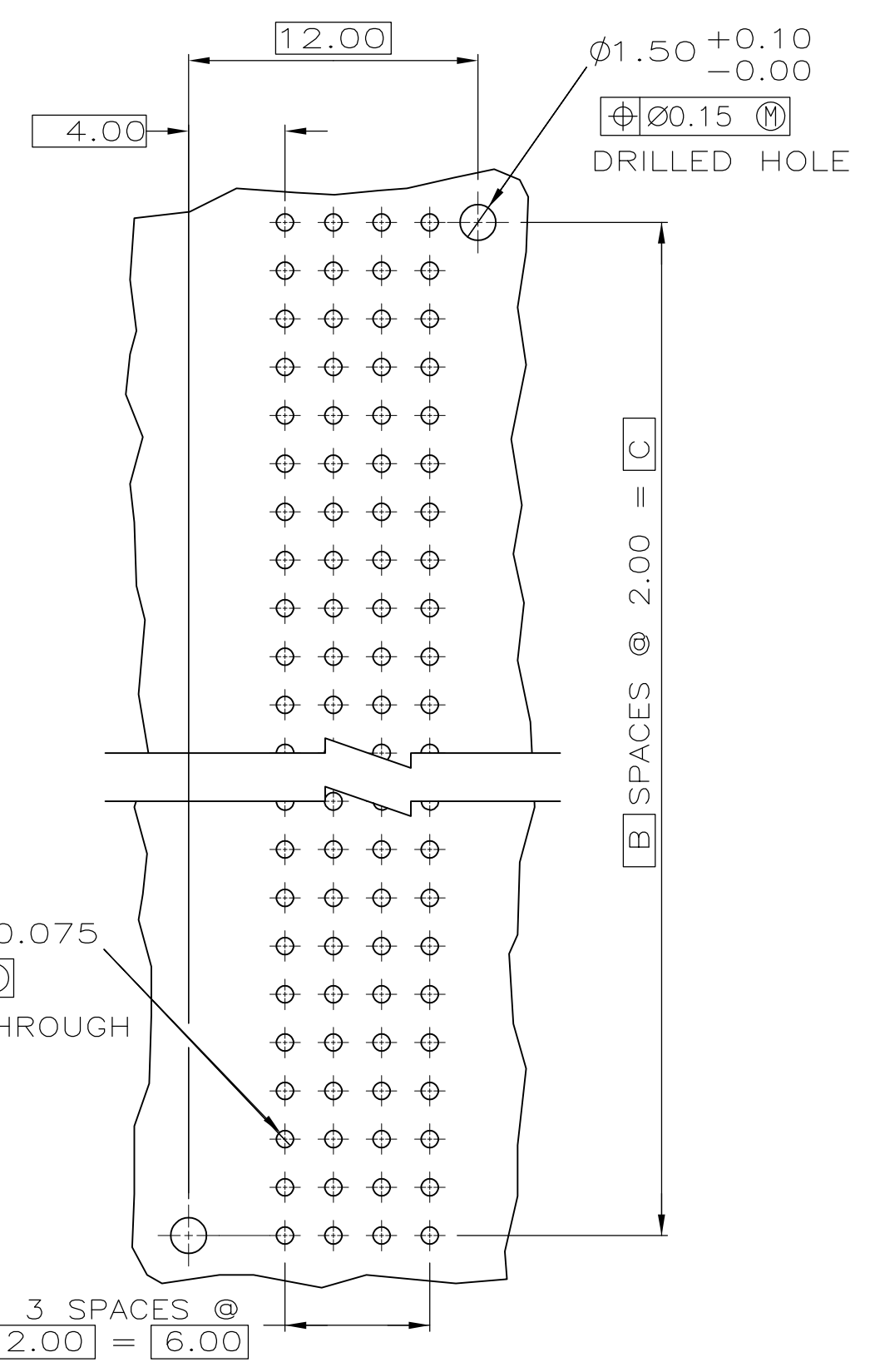

RECOMMENDED CIRCUIT PATTERN
PER IPC-D300 TYPE II, CLASS C
(COMPONENT SIDE)

- 1 HOUSING MATERIAL: LIQUID CRYSTAL POLYMER PER ASTM D5138 LCPO00 G30A 32250.
- 2 CONTACT MATERIAL: PHOSPHOR BRONZE PER UNS ALLOY NO. C51100, TEMPER: H04.
- 3 CONTACT FINISH:(E)
UNDERPLATE (ENTIRE CONTACT):
0.00127 MIN NICKEL PER SAE-AMS-QQ-N-290
ON MATING SURFACES:
FLASH GOLD PER ASTM B 488, OVER
0.00076 MIN PALLADIUM-NICKEL OVER UNDERPLATE, OR
0.00076 MIN GOLD PER ASTM B 488 OVER UNDERPLATE.
ON LEADS:
0.00381 MIN MATTE TIN PER ASTM B 545 OVER UNDERPLATE.
LUBRICATION (MIN MATING SURFACES):
SURFACE CONDITIONER AFTER PLATING.
- 4 PART MARKING, LOCATED APPROXIMATELY AS SHOWN.

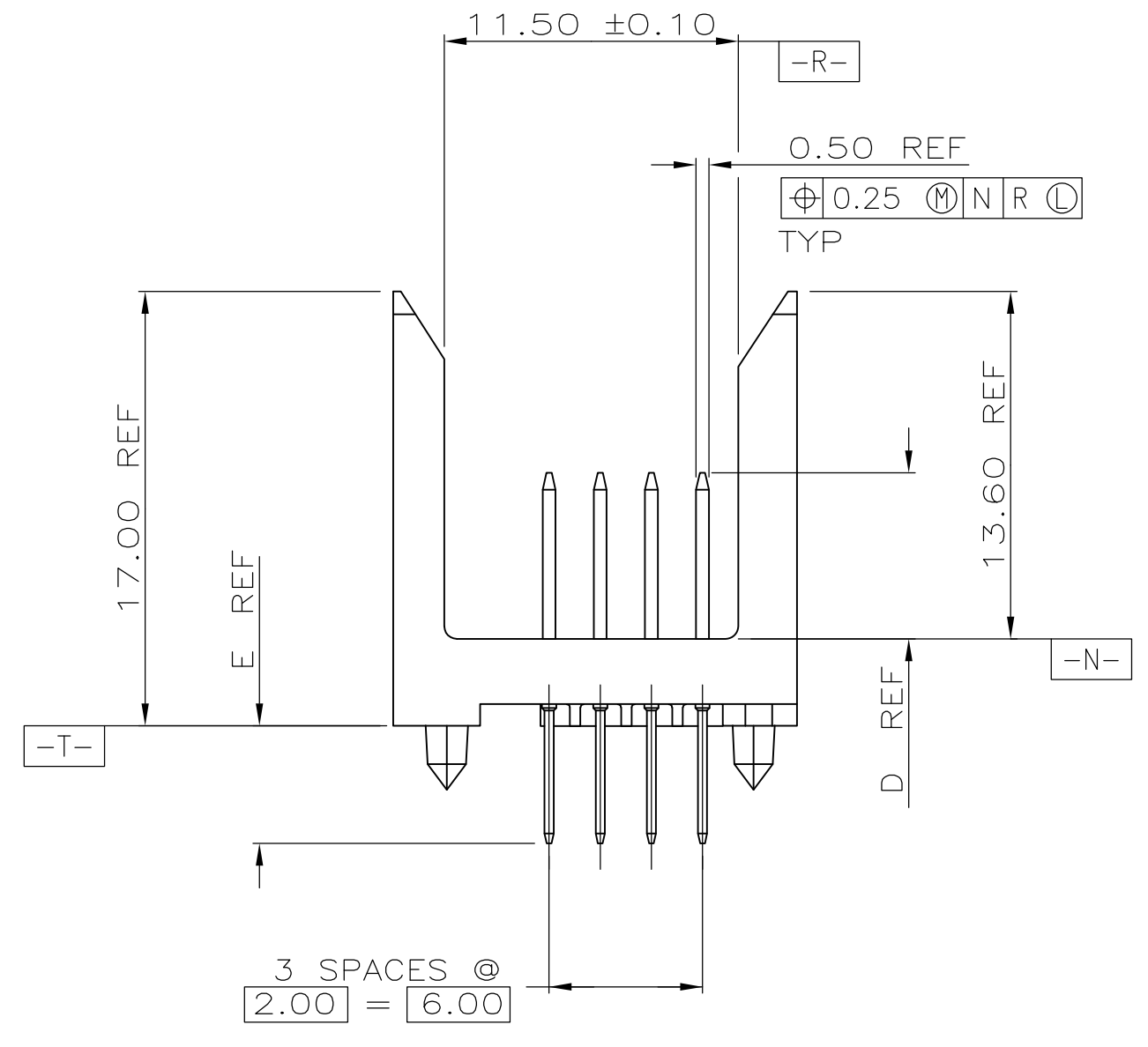
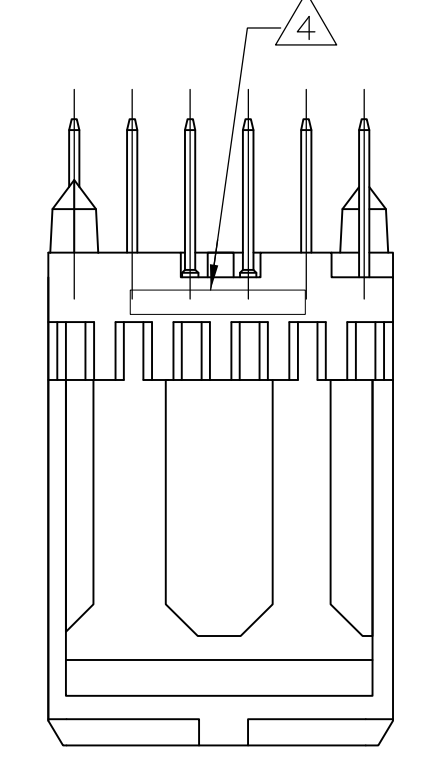
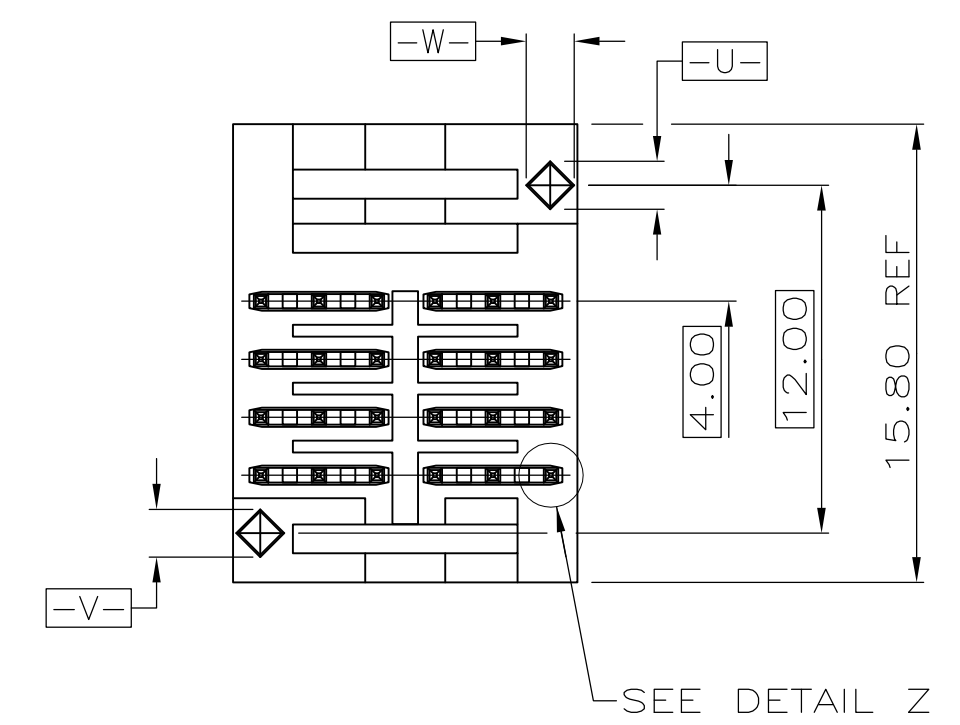
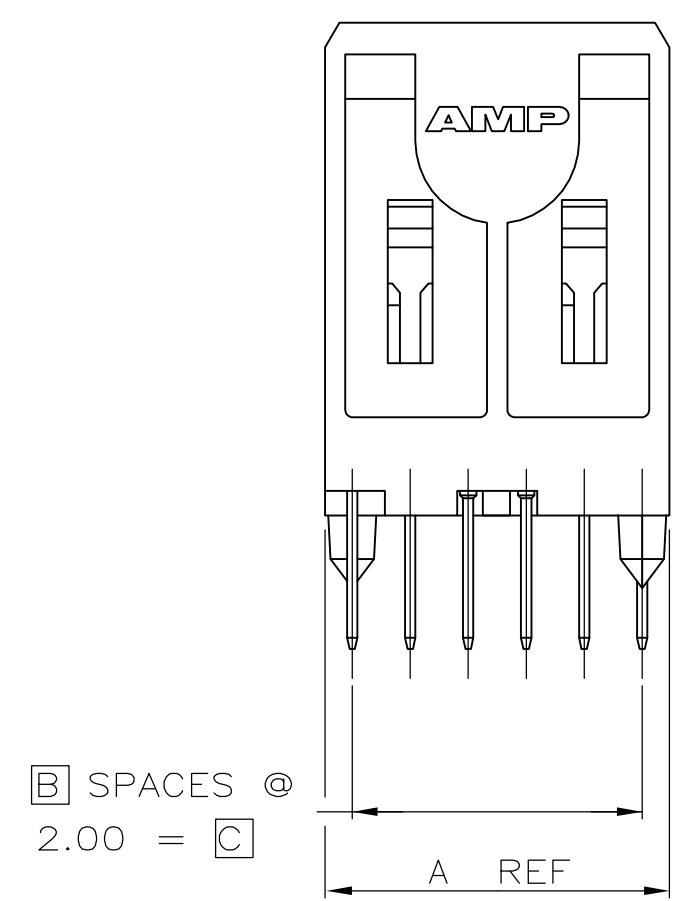
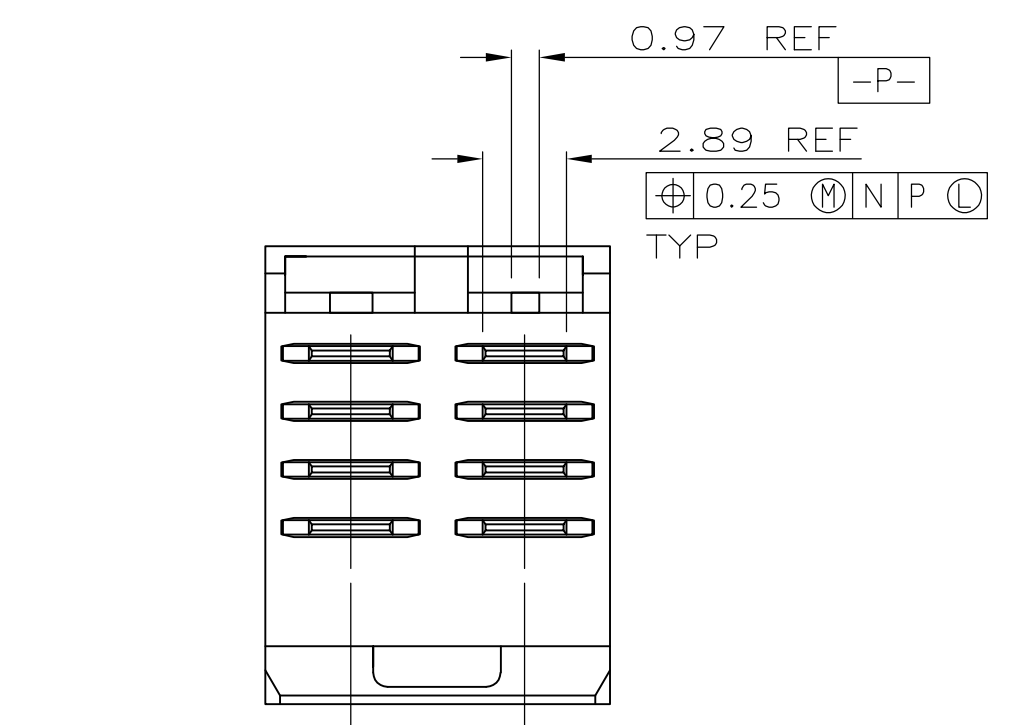
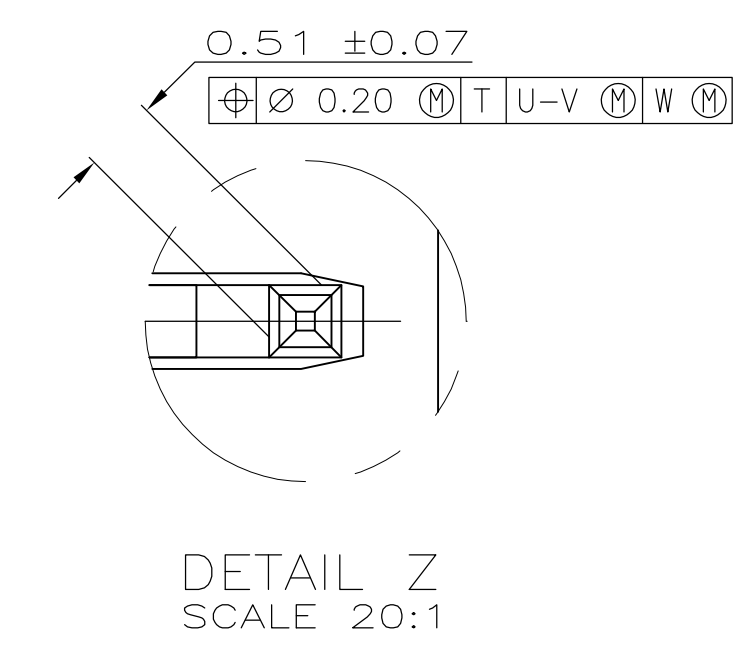

6.00	1	4.25	6.50	10.00	5	11.83	3	8	5536600-1
G	F	E	D	C	B	A	FINISH	NO OF POSN	PART NUMBER

THIS DRAWING IS A CONTROLLED DOCUMENT.		OWN D.R.BENDER 08/11/92	CHK R.L.BENDORF 09/03/92	APVD -	NAME Z-PACK 2mm FB, POWER MODULE, PIN ASSEMBLY 2mm CL, 4 ROW, TABLED MATING & LEAD LENGTHS
DIMENSIONS: mm	TOLERANCES UNLESS OTHERWISE SPECIFIED:	PRODUCT SPEC		APPLICATION SPEC	
0 PLG ± -	1 PLG ± -	WEIGHT		SIZE CAGE CODE DRAWING NO	
2 PLG ± 0.13	3 PLG ± -	CUSTOMER DRAWING		A1 00779 C=5536600	
4 PLG ± -	ANGLES ± -	SCALE 4:1		SHEET 1 OF 1	
MATERIAL	FINISH	REV P			